



Drawing Office Plan A

Time savings thanks to clear and accurate 3D drawings

Speed and accuracy are essential skills - all the more so in competitive industries like steel and metal engineering. Jennifer Thumberger, managing director of the drawing office Plan A, has so far been able to hold her own quite well. Just the other day, she transformed the planes of a Viennese educational institution into extremely appealing multifunctional zones - with pergolas, play areas and seating structures made of powder-coated, partly

galvanized steel. Some of the objects are covered by wooden slats, giving the schoolyard a warm-hearted flair: for example, wave-shaped lounging areas or benches with slightly inclined backrests. "Certainly no ordinary drawings," says Jennifer Thumberger cheerfully. HiCAD plays a supporting role in her success story, which is why the ISD Group asked a little more closely.

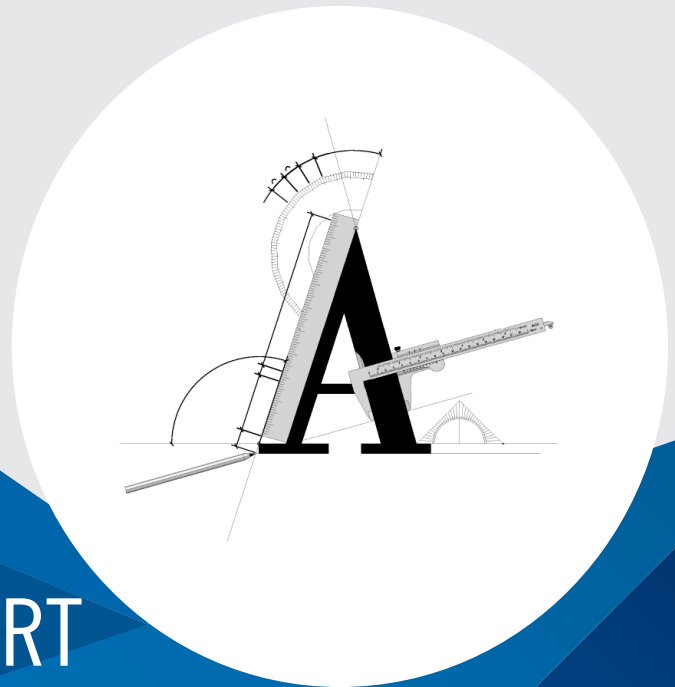

REFERENCE REPORT

ISD: How long has the drawing office Plan A been in existence?

Jennifer Thumberger: I started my own business in April 2021, due to the pandemic, and founded the drawing office Plan A.

ISD: And how exactly did the cooperation with ISD come about?

Jennifer Thumberger: In my previous company, also a client of ISD, I had the pleasure of working with HiCAD. Therefore, it was clear to me from the very beginning that I would only dare to take the step into self-employment with HiCAD.

ISD: Apart from HiCAD, what was your most important investment in the context of your self-employment? Or did you already have the necessary equipment?

Jennifer Thumberger: HiCAD was indeed my most important investment. Without reliable software, I would not have dared to take the step into self-employment in the first place! Apart from that, there was a new PC.

ISD: It certainly sounds like you don't regret this step at all and that the investment was worth it!

Jennifer Thumberger: So far it's going very well, much better than expected. I don't think I would have been able to do all this so easily without the solutions of the ISD Group.

ISD: We are very pleased about that. How easy was it for you to learn the design practice? Did you attend any training courses to apply HiCAD?

Jennifer Thumberger: No. I first wanted to try it out myself - autodidactically so to speak - with the material that ISD makes available, e.g. via videos on YouTube. That worked out great and with a little training, I quickly became an expert! However, the ISD's support is always available in case of an emergency.

“So far it's going very well, much better than expected. I don't think I would have been able to do all this so easily without the solutions of the ISD Group.”

Jennifer Thumberger, Managing Director of Plan A

ISD: With your service portfolio, you serve different industries such as the metal and steel construction industry including metalworking shops. What demands are placed on CAD drawings in your everyday work?

Jennifer Thumberger: Efficiency, speed and accuracy in cross-trade projects. Thank goodness I am not constantly confronted with new user interfaces in HiCAD so that I can, for example, make use of the special libraries and can quickly call up the necessary tools and functions for all adjacent areas via the HiCAD layout.

ISD: Which HiCAD modules do you use?

Jennifer Thumberger: The Metal Engineering suite premium. Best choice for steel engineering/metalwork/metal technology including sheet metal processing. Also in terms of the creative leeway you gain.

ISD: Can you go into more detail about the creative scope?

Jennifer Thumberger: HiCAD's steel engineering connection libraries helped me with the pergolas, for example. I can work very creatively thanks to spectacular 3D views in my execution plans. Especially customers who only know 2D can be impressed by this. The possibility of modelling freely - i.e. not only based on history - also gives me the

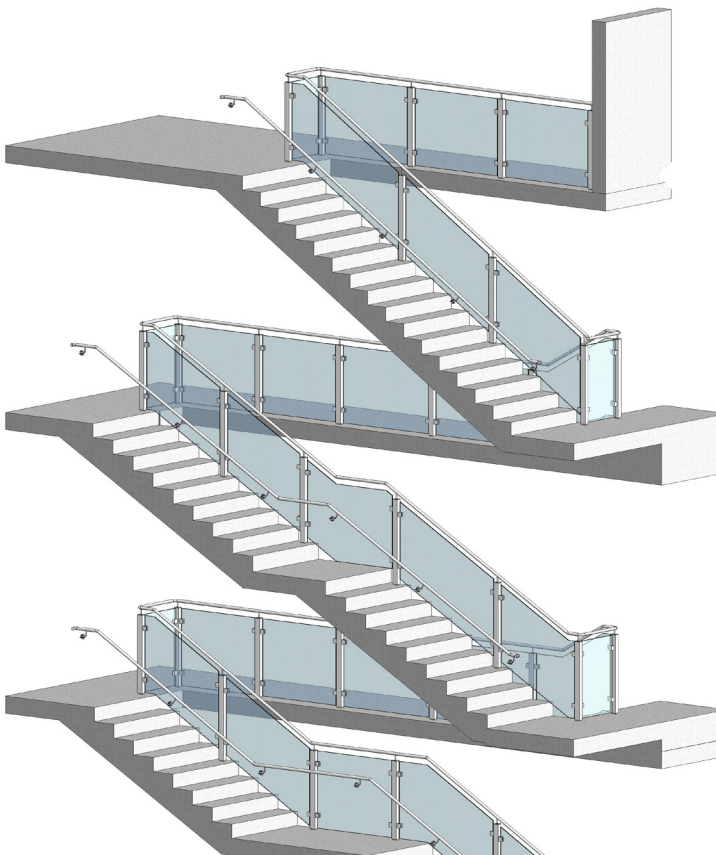

Image: © Drawing Office PLAN A

advantage in HiCAD of being able to react quickly to change requests.

“When I create a detailed design, I generate as many 3D views as possible and thus save myself the trouble of exact detailing and dimensioning in 2D.”

Jennifer Thumberger, Managing Director of Plan A

ISD: Are there other functions that you would no longer want to do without?

Jennifer Thumberger: Yes. The user-friendly dialogue for the Detail view Cuboid/Sphere, for example, which can be found in the HiCAD menu. Furthermore, the Staircase and Railing Configurator, which were used for the representative main staircase of the school building - with its glass railing infill and elegant stainless steel handrail.

ISD: For what kind of drawings would you say HiCAD is best used?

Jennifer Thumberger (laughs): For anything and everything! I really design everything well and with pleasure with HiCAD. But if you like, I also enthusiastically deal with drawings that are not only rectangular - like the wave-shaped seating in the schoolyard in Vienna's Langobardenstraße, for example. You need a much larger time window for that in 2D.

ISD: Do you still design in 2D from time to time?

Jennifer Thumberger: No. I don't use 2D at all, except to import architects' plans. When I create a detailed design, I generate as many 3D views as possible and thus save myself the trouble of exact detailing and dimensioning in 2D.

ISD: You indirectly implied earlier that you are faster with 3D. Can you explain this in more detail?

Jennifer Thumberger: There have been hardly any queries from the architect and timber supplier regarding my 3D visualisations. What more could you want?

ISD: Can you perhaps tell us - roughly estimated - how much time is saved compared to 2D planning?

Jennifer Thumberger: It is always difficult to quantify the exact time saved. But if I say that I save about 30%, I think that's a good estimate.

ISD: In any case, it sounds as if you have been able to achieve the goals you have set so far in terms of efficiency and increased productivity with HiCAD?

Jennifer Thumberger: It is indeed like that!

ISD: What do you recommend to other companies that want to reposition themselves in the field of CAD?

Jennifer Thumberger: I'm happy if everyone else doesn't work with HiCAD.

ISD: How can we understand that?

Jennifer Thumberger (laughs): Because then I stand out from the crowd and can score with speed as well as beautiful 3D views!

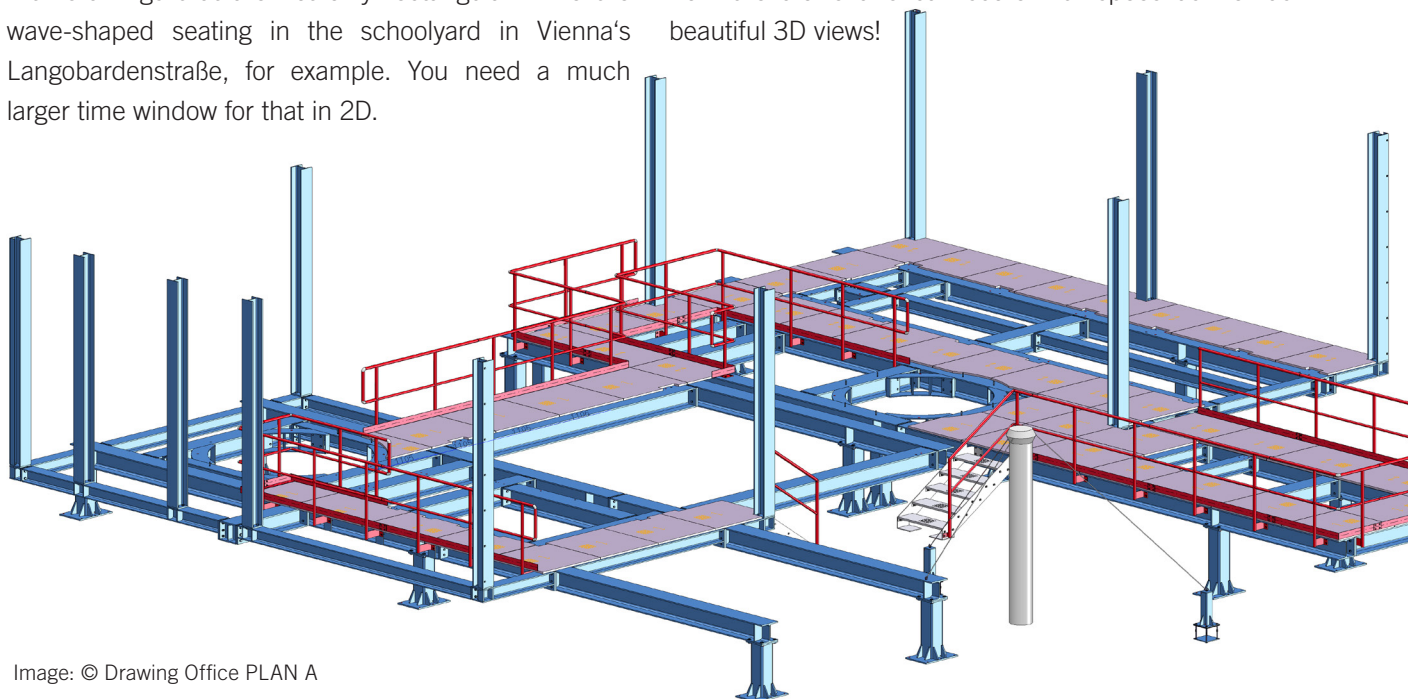

ISD: I see! Yes, the competition is tough.

Jennifer Thumberger: Absolutely. If you want my opinion: You soon won't be able to survive on the market with 2D CAD programs alone. You only have to look at the topic of BIM. I don't work with BIM yet, because unfortunately the majority of other companies don't yet work with BIM - let alone with 3D programmes. But the course has been set: With 3D CAD software like HiCAD.

ISD: That's great to hear. We thank you for the insights into your everyday design work and wish you continued success!

Brief company profile:

- > Drawing office PLAN A
- > Industry: Metal and steel engineering, sheet metal processing
- > Software: HiCAD
- > Services: Facades, metal and steel constructions
- > www.zeichenbüro-plan-a.at/

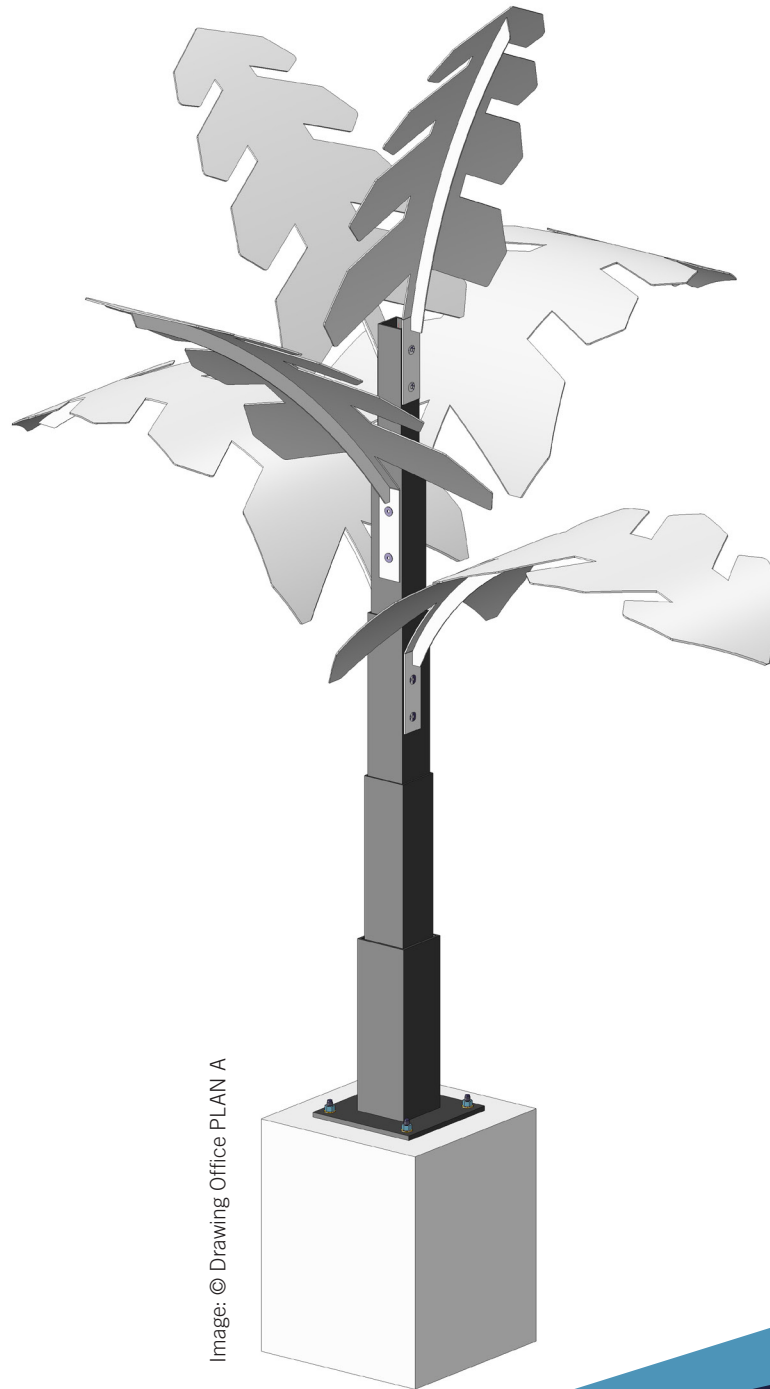

Image: © Drawing Office PLAN A



Success requires a strong partner!

Check out our software solutions. We will show you further advantages in a personal presentation or a free consultation appointment. Feel free to contact us. We are happy to be there for you.

ISD Software und Systeme GmbH

Tel.: +49-(0)231-9793-0

Mail: info@isdgroup.de

Web: www.isdgroup.com